

1. INTRODUCTION:

This instruction manual contains important information regarding the safety instructions, installation, operation, maintenance and storage of the "Guardbox" limit switch boxes.

The limit switch boxes may only be mounted, wired and installed by qualified and trained personnel, according to International standards requirements for hazardous areas. If you require any additional information or assistance, please contact the manufacturer or its representative. All contacts are listed in the footnote together with the QR code for an easy access to the complete product documentation. Please read these instructions carefully before proceeding with the limit switch box installation and save them for future reference.

2. PRODUCT DESCRIPTION:

Guardbox Limit switch boxes are electromechanical devices ideal for monitoring the remote operation of industrial valves in plants, designed and manufactured for demanding application in extreme environments and where there are requested high standards for safety and reliability products. The Guardbox devices are used to control the position of the valve and provide high accuracy electrical feedback signal of valve status to plant control systems. Guardbox devices are equipped in standard configuration with a 3D high visibility position indicator that represent a true indication of valve position. The indicator is visible on all 4 sides and is fully adjustable on 360° without disassembly. Guardbox limit switch boxes are built to be installed on valves or actuators which drive the process valves from closed to open position (Normal acting) or from open to closed position (Reverse acting) . *Normal acting* is considered full CW when the process valve is closed and CCW when the process valve is open. *Reverse acting* is full CW when the process valve is open and CCW when the process valve is closed.

3. SAFETY INSTRUCTIONS:

Guardbox Limit switch boxes are electromechanical devices ideal for monitoring the remote operation of industrial valves in plants, designed and manufactured for demanding application in extreme environments and where there are requested high standards for safety and reliability products. The Guardbox devices are used to control the position of the valve and provide high accuracy electrical feedback signal of valve status to plant control systems. GD Guardbox explosion proof Exd series limit switch box are specially projected and built to withstand the most extreme weather conditions and be installed into hazardous areas with flammable gases, vapours and mist, according with the relevant Union harmonization legislation of ATEX Directive 2014/34/EU, and to IECEx Scheme and applicable standards. Reference standards are the IEC60079-0:2011 (Ed6.0), IEC60079-1:2014-06 (Ed7.0), and IEC60079-31:2013 (Ed2.0) for IECEx, EN IEC 60079-0:2018 , EN 60079-1:2014 , EN60079-31:2014 and the applied marking of Group, category and applied Ex protection is:

Ex – Equipment Marking

 II2G Ex db IIC T6...T4 Gb
II2D Ex tb IIIC T85°C...T135°C Db

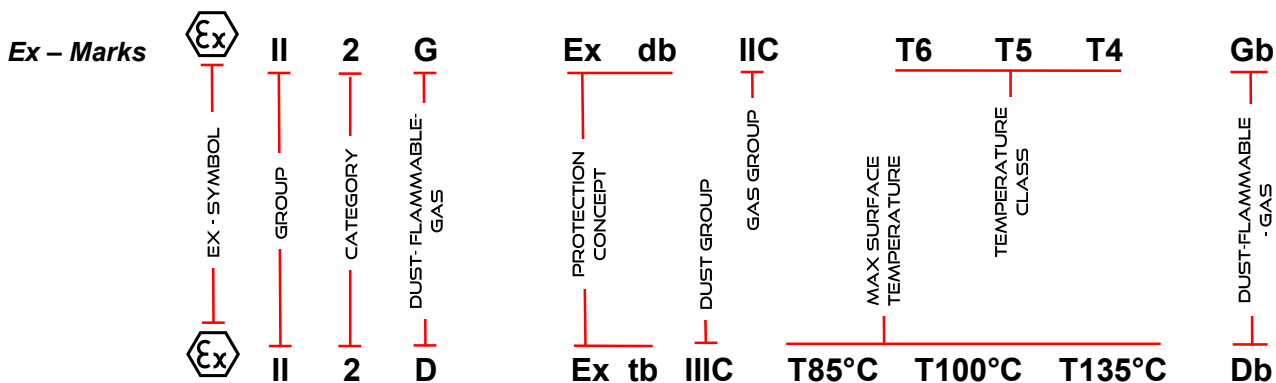

On the outside of the Exd box cover there are two metal nameplates on which are etched and marked the Ex-marking and all the information and references about the manufacturer, electrical and ambient range of use of the specific product, together with a Data Matrix code for a quick link and easy access to the product documentation including wiring diagram, drawings, datasheet and certificates:



Ex – Equipment Marking

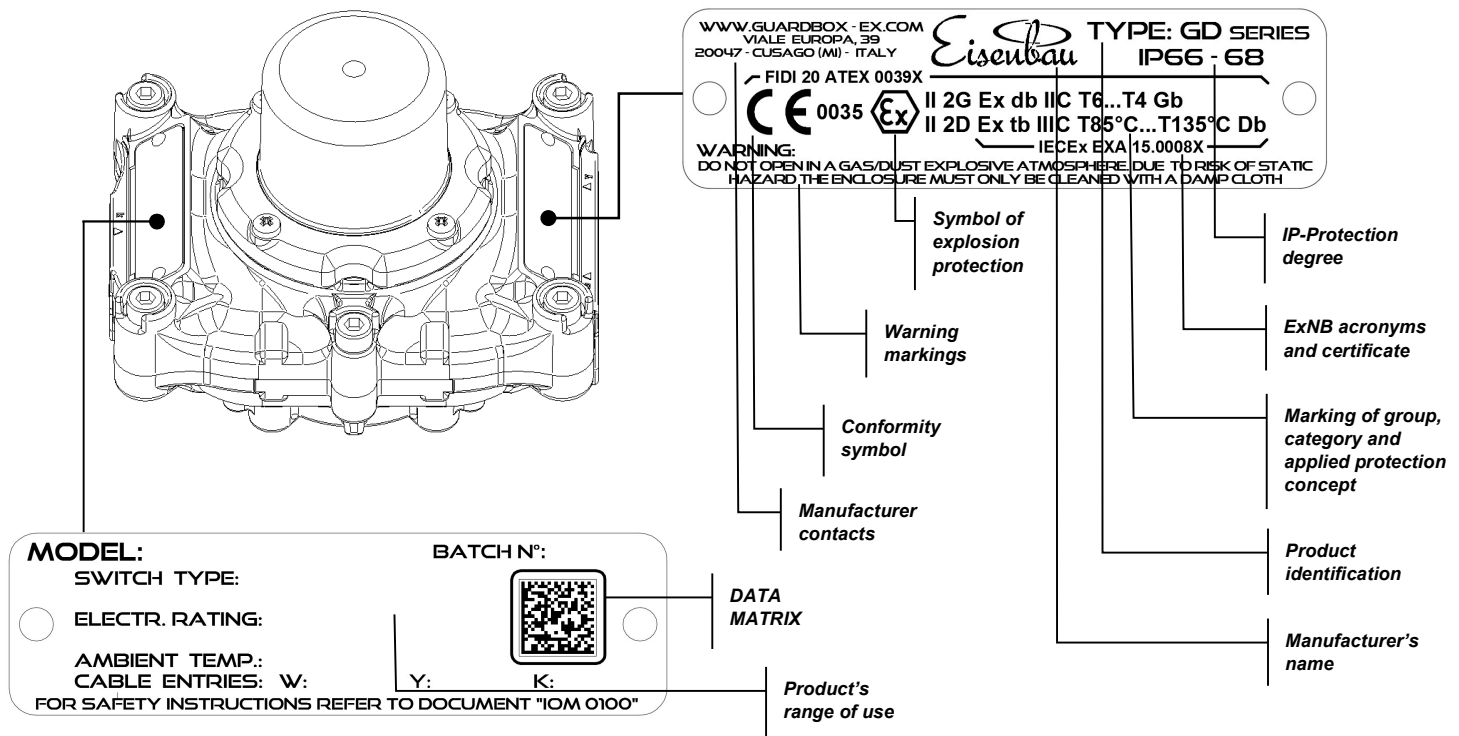

The certification relies upon the following materials used in its construction: Box housing made up of body and cover is in Stainless Steel AISI316L, or Aluminum Alloy EN AB ed AC 44300 Al Si 12 (Fe) (a). In order to comply with the requirements for the equipment protection level (EPL), the material of the enclosure must be chosen as follow:

Table 1 – Relation between EPL and type of material of the enclosure

EPL (EXPLOSION PROTECTION LEVEL)		ENCLOSURE MATERIAL (According to 60079-0 section 8.3)
<i>GASES</i>	<i>DUSTS</i>	Aluminium Alloy EN AB ed AC 44300 Al Si 12 (Fe) (a) or Stainless steel 316L (CF3M)
<i>Gb / Gc</i>	<i>Db</i>	

Box gasket is in silicone rubber. It is the responsibility of the user to ensure that all the following safety instructions, essential health and safety requirements and warnings are observed during installation, operation and maintenance of the product:

- 3.1 These instructions must carefully read before proceeding with the limit switch box installation and saved for future reference.
- 3.2 Installation should be carried out by suitably trained personnel to an applicable Code of Practice (eg. EN60079-14)
- 3.3 If the box is integrated in a system or in a plant, the customer shall ensure that the local safety regulations are observed.
- 3.4 Before proceeding with the wiring, make sure that the characteristics of the electrical connection are compatible with electrical operation parameters of operation of the box.
- 3.5 Do not exceed the limit switch box performance limitation. Exceeding the limitation may cause damage to the limit switch, actuator and valve.
- 3.6 Where the temperature under rated conditions is higher than 70°C at the entry point or 80°C at the branching point of the conductors, use field wiring suitable to work at minimum and maximum ambient operating temperature indicated on the external nameplate of the box.
- 3.7 Operating the box over temperature limits will damage internal and external components.
- 3.8 **RISK OF SEVERE INJURIES!:** Do not open the box when energized or in presence of explosive atmospheres.
- 3.9 Guardbox products are supplied with plastic caps fitted on the customer requested cable entries. Task of these caps is to protect the internal circuits of the products in the time between manufacturing and commissioning. It is responsibility of the installing personnel to replace the protective caps with suitably certified and temperature rated cable glands and blanking plugs in a type of protections *Exdb* (flameproof enclosures) and *Extb* (by enclosure).
- 3.10 Product IP rating is ensured only by the use of suitable IP rated cable glands and plugs.
- 3.11 All cable entry devices shall be certified in type of explosion protection 'd' and suitable for the area classification in accordance with the National Electrical Code.
- 3.12 Any unused cable entries must be sealed with suitably certified stopping plugs.



IOM (Installation, Operation & Maintenance Manual) 0100-ENG rev.7

3.13 The box is provided with two grounding connection facilities, one inside and one outside the housing. The facilities allow for the effective connection of at least one conductor with a cross-sectional area given below in table (2):

Table 2 – minimum cross-sectional area of protective conductors

CROSS-SECTIONAL AREA OF PHASE CONDUCTOR, S [mm ²]	MINIMUM CROSS-SECTIONAL AREA OF THE CORRESPONDING PROTECTIVE CONDUCTOR, S _p [mm ²]
S ≤ 16	S
16 < S ≤ 35	16
S ≥ 35	0,5S

- 3.14 For Explosion Proof installations, the internal ground connection shall be used. The external ground connection, is an additional wiring allowed where local authorities permit, or is required. Use a ground wire of proper cross section.
- 3.15 Both internal and external grounding connections are clearly identified and permanently marked on the box housing and are projected to facilitate the installation of the ground cable preventing it from rotating.
- 3.16 A grounding connection kit composed by n°2 phillips head screws plus n°2 toothed washers, is provided in a sealed bag, available inside the box. The two anti-vibration washers help to ensure the securing of the cable.
- 3.17 **⚠ WARNING!**: Risk of electrostatic charges accumulation on non-conductive parts of the box (eg. Plastic indicator dome). The external surfaces of the box must be preserved by the accumulation of dust through periodic cleaning. Clean Only with a Damp Cloth.
- 3.18 No maintenance or repair of the flameproof enclosure is permitted. For additional assistance, please contact the manufacturer.
- 3.19 **⚠ CAUTION!**: The metallic alloy used for the housing material may be at the accessible surface of this equipment; in the event of rare accidents, ignition sources due to impact and friction sparks could occur.
- 3.20 **⚠ CAUTION!**: The box can work in plants in presence of extreme environments and in contact with highly aggressive and corrosive substances that may affect the integrity of the product and its protection mode. To operate in such conditions the box is projected to be realized in different materials that ensure durability and reliability in operation. For the right choice of the available options, please contact Eisenbau.

4. EU - DECLARATION OF CONFORMITY IN ACCORDANCE WITH THE RELEVANT UNION HARMONIZATION LEGISLATION ATEX DIRECTIVE 2014/34/EU

The manufacturer Eisenbau s.r.l. herewith declare under his sole responsibility, that the limit switch boxes GD-series complies, when installed in accordance with the installation and safety instruction, with all the following applicable EU directives, Regulations and all the essential Health and Safety requirements:

Ex – Equipment Marking





IIG Ex db IIC T6...T4 Gb
IIG Ex tb IIC T85°C...T135°C Db

IEC 60079-0:2011 (Ed6.0); IEC 60079-1:2014-06 (Ed7.0); IEC 60079-31:2013 (Ed2.0)
EN IEC 60079-0:2018; EN 60079-1:2014; EN 60079-31:2014

ATEX EC – Type examination certificate: FIDI 20 ATEX 0039X
IECEx – Certificate of Conformity: IECEx EXA 15.0008X

ATEX - Production Quality Assurance Notification: 01 220 1909020
IECEx - Product Quality Assessment Report : DE/TUR/QAR/19.0006/00

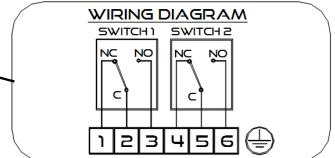
5. INSTALLATION:

QR CODE OR DATA MATRIX TO DIRECTLY DOWNLOAD DRAWINGS, WIRING DIAGRAMS, MANUALS AND CERTIFICATES DIRECTLY ON FIELD



6. MOUNTING:

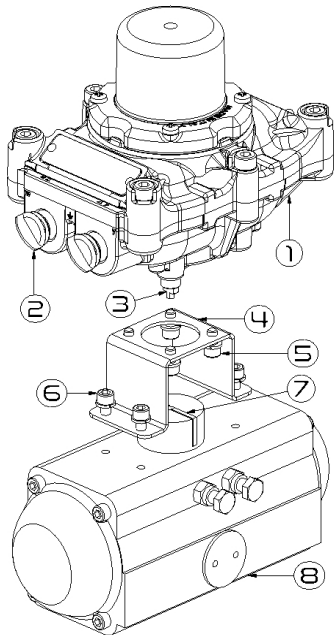

BOX MOUNTED PARALLEL TO THE ACTUATOR

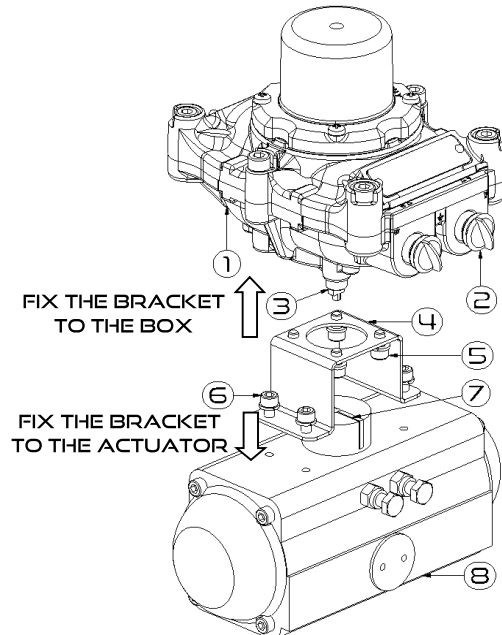

BOX MOUNTED PERPENDICULAR TO THE ACTUATOR

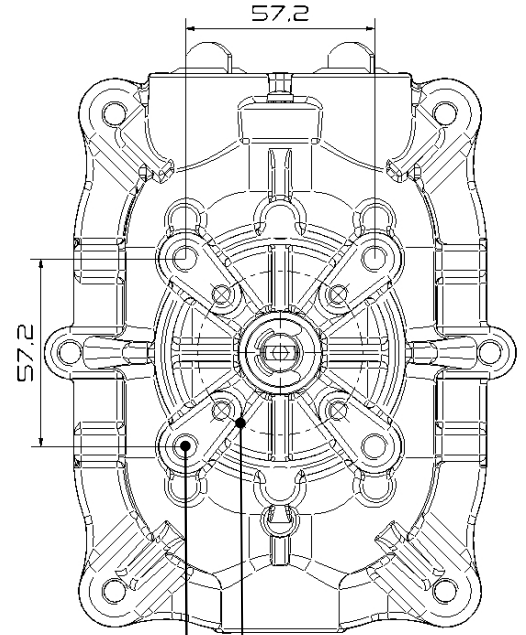

Ø50 ISO F05 ACCORDING TO ISO 5211 N° 4 HOLES - M6X10

ADDITIONAL MOUNTING HOLES (ON REQUEST)

⚠ ATTENTION! : Consider the rotation direction of the actuator. The box is factory presetted to be installed parallel to CCW rotating actuators (Normal acting). For installation on reverse acting actuator or perpendicular to the actuator, the cams inside the box need to be reset before operating the system to avoid damages to the cams or to the sensors.

- 6.1 The box has on the bottom surface a drilling according to ISO 5211, as shown in the image. Fix the proper mounting bracket (supplied in option by Eisenbau) to the box using M6 screws (6).
- 6.2 Move the actuator to a completely "Open" or "Close" position, then align the box shaft (3) to actuator slot (7) ensuring of their correct coupling.
- 6.3 The box is designed, assembled and controlled to ensure a maximum operating torque, at the shaft, lower than 0,5Nm. An excessive misalignment of the two shafts during coupling, may result in the increase of this torque value until reaching the complete seizure of the shaft in the worst cases. Eccentricity between the two shafts must not exceed 0.2 mm.
- 6.4 The motion transmission from the actuator or valve to the box GD is attained by a mechanical coupling. Before installation on a valve or an actuator, make sure that the orientation of the position indicator is correct.
- 6.5 Operate the actuator before making the electrical wiring to ensure proper alignment between box and actuator . If it should be necessary, re-align box by loosening mounting bolts (6) and retighten bolts to the actuator (8) according to the required direction of rotation when satisfied with alignment.
- 6.6 Replace the protective caps with suitably certified and temperature rated cable glands and blanking plugs permitted for use with ATEX / IECEx flameproof enclosures.

7. ELECTRICAL WIRING:

⚠ CAUTION !: The electric components inside the box may carry dangerous voltage. The box must not electrically connected during installation.

Follow switch adjustment, wiring instructions (if present) and indicator setting before servicing the limit switch box. Make sure that the characteristics of the electrical connection are compatible with electrical parameters of operation of the Limit switch box. Do not exceed the limit switch performance limitation. Exceeding the limitation may cause damage to the limit switch, actuator and valve. Connect earth conductor.

⚠ ATTENTION !: the minimum clearance required to remove the box cover is 60mm.



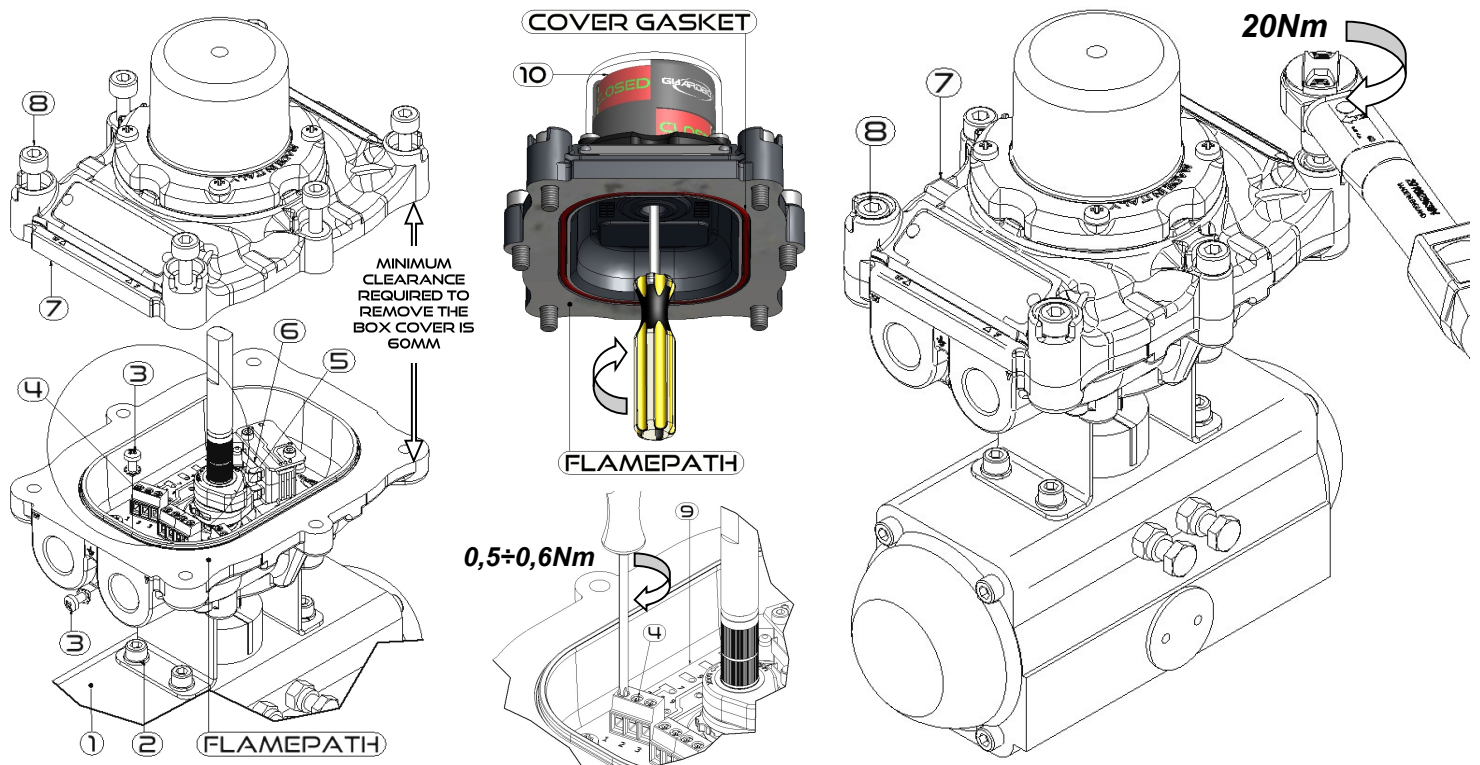

- 7.1 Replace the protective caps with suitably certified and temperature rated cable glands and blanking plugs in a type of protections *Exdb* (flameproof enclosures) and *Extb* (by enclosure).
- 7.2 Product IP rating is ensured only by the use of suitable IP rated cable glands and plugs
- 7.3 Make sure that the cable glands are steadily tightened so that the sealing ring reaches the proper compression to avoid the transmission of mechanical stresses to the terminals (4).
- 7.4 Number, position and size of the provided cable entries are specified in the adhesive label outside the box cover. Number and type of cable entries can also be determined by reference to the 4th digit of limit switch box model marked on both internal and external labels. The certified cable entry options in the following table (3):

Table 3 – Cable entry options

ENTRY SIZE Ex				MAX QUANTITY *
M20x1,5	M25x1,5	1/2"NPT	3/4"NPT	N°3
Metric thread conform to UNI 5870:1971 NPT thread conform to ANSI/ASME B1.20.1:1983				

* Every box housing can be customized with a various combination , in quantity and size, of cable entries up to a maximum of 3 , depending on customer request

- 7.5 Unscrew the six box cover captive screws (8) , then remove the box cover (7).
- 7.6 Use cables suitable for temperature class as specified in following table (4):

Table 4 – Suitable cable temperature class

Ta max [°C]	* Maximal allowed power dissipation [W]	Temperature class	Maximum surface temperature	Suitable cable temperature class
40	4	T6	85°C	70°C
	10	T6	85°C	70°C
65	4	T6	85°C	80°C
	10	T5	100°C	100°C
85	4	T5	100°C	100°C
	10	T4	135°C	120°C
90	4	T4	135°C	105°C
	10	T4	135°C	125°C
105	4	T4	135°C	120°C

* Refer to label/s attached inside the box cover

NOMINAL RANGE OF USE

Ambient temperature:
-60°C ≤ Ta ≤ 105°C

Nominal voltage:
0 – 125 VDC
0 – 250 VAC

Nominal current:
0,1 – 10 A

- 7.7 Connect field wiring to the terminals (4) within the circuit board (9) according to the wiring diagram and terminal labelling available inside the box.
- 7.8 Make sure that the electrical wires are steadily tightened and totally inserted into the terminals (4) and that there isn't non-insulated conductor material.
- 7.9 For box with circuit board (9) installed, the terminals (4) must be tightened using a torque value between 0,5±0,6Nm.



IOM (Installation, Operation & Maintenance Manual) 0100-ENG rev.7

- 7.10 Make sure that the box is connected to the ground with the proper screw (3) using a ground cable with a suitable section
- 7.11 For switch adjustment and cams (5) setting, please refer to following section (8. SWITCH AND CAM SETTING).
- 7.12 Check the cams (5) position before replacing the box cover (7).
- 7.13 **⚠ ATTENTION !** : During the steps of removal and adjustment it is possible that the cover gasket moves from its operating position. Verify that it is in the seat during assembly because the incorrect positioning of the gasket may cause malfunctions in the box.
- 7.14 **⚠ ATTENTION !** : body and cover in the aluminum version, have a protective conductive coating against corrosion on the flamepaths. Do not apply any kind of grease on the flame-paths, this may cause the accumulations of dirt or particles that may increase the maximum constructional gap, prescribed by normative, between box body and cover, compromising the flameproof protective method.
- 7.15 Replace the cover (7) making sure that the orientation of the position indicator (10) is correct. If the cover (7) is hard to engage on the box shaft, the indicator (10) could have moved during box cover's opening. Use a phillips screwdriver to match the 3D indicator slot with the box shaft, than reassemble the cover (7).
- 7.16 Fasten the six captive screws (8) using a torque of 20Nm.

8. SWITCH AND CAM SETTING:

⚠ NOTE !: Cams are factory presetted in order to operate in a box installed parallel (See section 6. MOUNTING) to CCW rotating actuators (Normal acting). The lower cam (1) is regulated to operate the switch in the full CW position, when the process valve is **CLOSED**. The cam above (2) is regulated to operate the switch in the full CCW position, when the process valve is **OPEN**. All installation are suitably accompanied by dedicated instructions, due to the size of the installed sensor, cams may have the opposite regulation. Some applications moreover require the use of additional or special cams. These cams, placed above the cam (2), can be set for signaling intermediate positions or as a redundant signaling of valve **OPEN** or **CLOSED**. Where necessary, will be provided dedicated additional instructions for the proper setting of the special cams or electrical components. Following table represent the main cam configurations divided by specific type of switch, for applications not represented below, please refer to additional instructions provided inside the box packaging:

CAM EASY ADJUSTABLE REGULATING SYSTEM

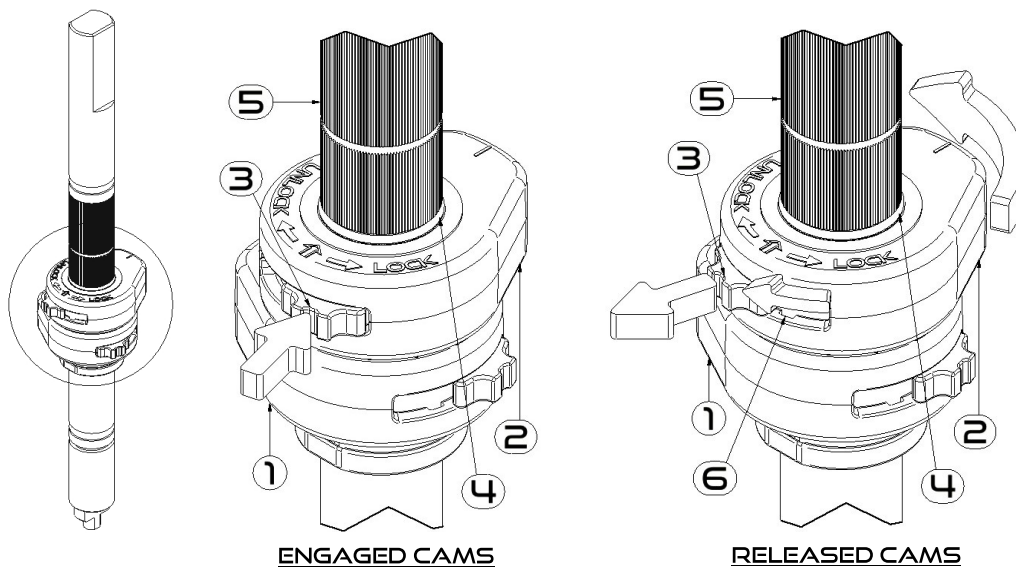

NO TOOL IS REQUIRED FOR THE REGULATION OF THE CAMS.

- Push the button (3) with the finger up to disengage the cam from its retaining seat (6), rotate CW the button until it stops, then release. Now the cam is free to rotate on the shaft (5). Retaining spring (4) prevent the cams to lift up during regulation.
- Rotate the cam till reaching the correct operating point
- Push the button (3) with the finger up to disengage the cam from its retaining seat (6), rotate CCW the button until it stops, then release. Now the cam is settled and locked on the shaft (5).

<p>ES / ED (ELECTROMECHANICAL SPDT/DPDT)</p>	<p>BOARD ASSEMBLY</p>	<p>TURN THE ACTUATOR PINION FULL CW AND REGULATE THE CAM TILL THE SWITCH (1) IS ACTIVATED</p>	<p>TURN THE ACTUATOR PINION FULL CCW AND REGULATE THE CAM TILL THE SWITCH (2) IS ACTIVATED</p>
---------------------------------------------------------	------------------------------	-----------------------------------------------------------------------------------------------	------------------------------------------------------------------------------------------------



GUARDBOX - GD SERIES

IOM (Installation, Operation & Maintenance Manual) 0100-ENG rev.7

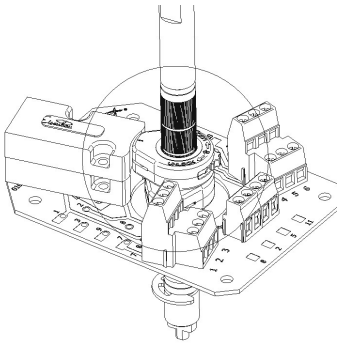
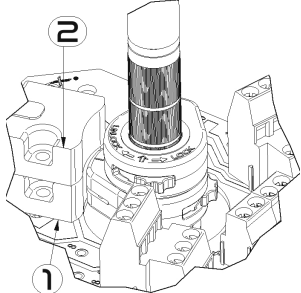
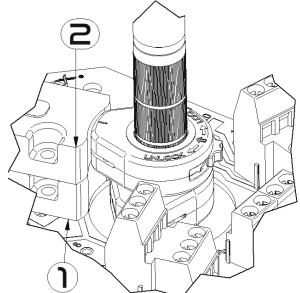
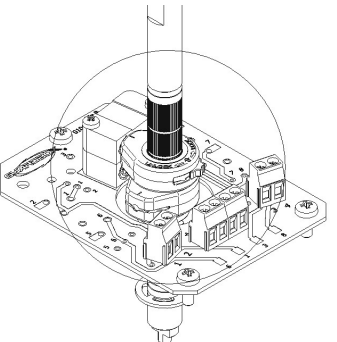
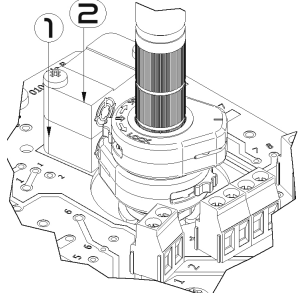
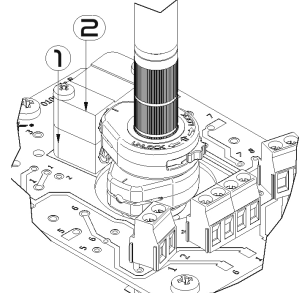
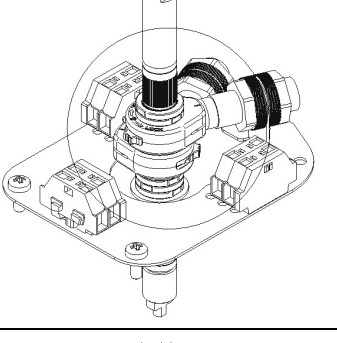
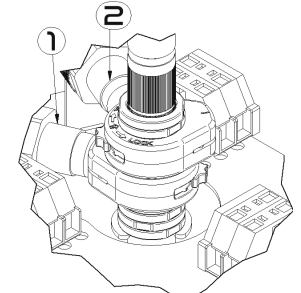
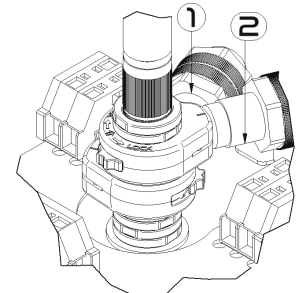
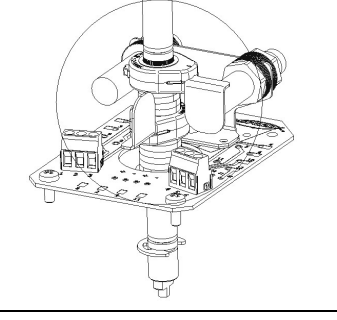
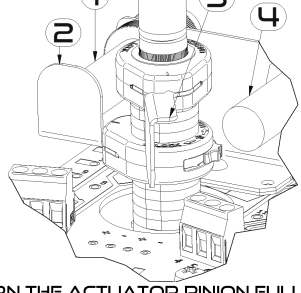
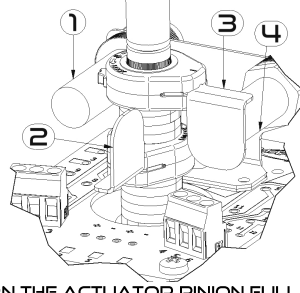
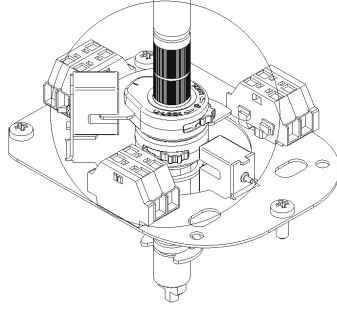
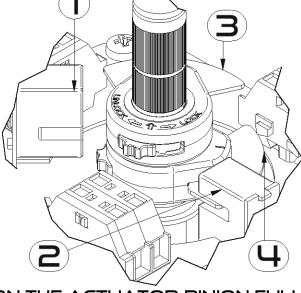
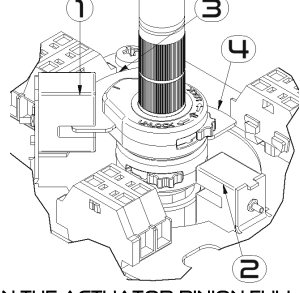
<p>MS / MD (MAGNETIC PROXIMITY SPDT/DPDT)</p>	<p>BOARD ASSEMBLY</p> 	 <p>TURN THE ACTUATOR PINION FULL CW AND REGULATE THE CAM TILL THE SWITCH (1) IS ACTIVATED</p>	 <p>TURN THE ACTUATOR PINION FULL CCW AND REGULATE THE CAM TILL THE SWITCH (2) IS ACTIVATED</p>
	<p>BOARD ASSEMBLY</p> 	 <p>TURN THE ACTUATOR PINION FULL CW AND REGULATE THE CAM TILL THE SWITCH (1) IS ACTIVATED</p>	 <p>TURN THE ACTUATOR PINION FULL CCW AND REGULATE THE CAM TILL THE SWITCH (2) IS ACTIVATED</p>
<p>PI / PN (INDUCTIVE PROXIMITY) / (INDUCTIVE PROXIMITY NAMUR)</p>		 <p>TURN THE ACTUATOR PINION FULL CW AND REGULATE THE CAM TILL THE SWITCH (1) IS ACTIVATED</p>	 <p>TURN THE ACTUATOR PINION FULL CCW AND REGULATE THE CAM TILL THE SWITCH (2) IS ACTIVATED</p>
		 <p>TURN THE ACTUATOR PINION FULL CW AND REGULATE THE CAM TILL THE SWITCH (1) IS ACTIVATED</p>	 <p>TURN THE ACTUATOR PINION FULL CCW AND REGULATE THE CAM TILL THE SWITCH (4) IS ACTIVATED</p>
		 <p>TURN THE ACTUATOR PINION FULL CW AND REGULATE THE CAM TILL THE SWITCH (1) IS ACTIVATED</p>	 <p>TURN THE ACTUATOR PINION FULL CCW AND REGULATE THE CAM TILL THE SWITCH (2) IS ACTIVATED</p>



IOM (Installation, Operation & Maintenance Manual) 0100-ENG rev.7

9. INDICATOR SETTING:

- 9.1 The 3D indicator (2) is visible on all 4 sides and is fully adjustable on 360° without disassembly.
- 9.2 Loosen indicator M5 captive screws and rotate transparent indicator dome (1) to desired viewing angle according to valve position. (OPEN or CLOSED appearing through indicator window).
- 9.3 Retighten the four captive M5 screws (3) using a torque of max **3,5Nm** for standard plastic dome while, for glass dome version, do not exceed the max torque of **0,5Nm**.

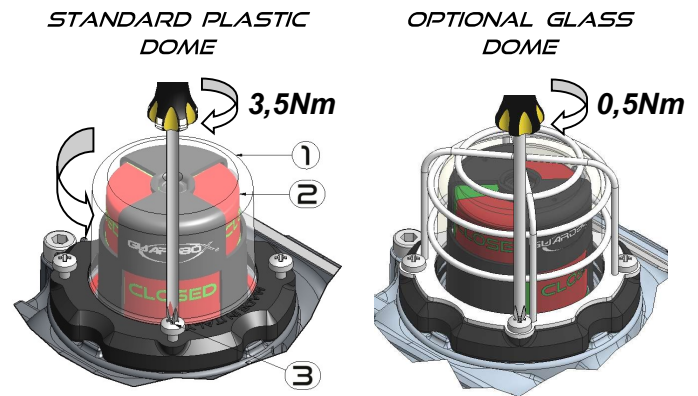

10. STORAGE AND MAINTENANCE:

- 10.1 Store the boxes away from UV rays and atmospheric agents, in an environment with temperature between 0°C and 40°C.
- 10.2 The Guardbox devices require no servicing during normal working life if properly installed, except the normal inspection of mounting screws/bolts, O-rings and terminal wiring for signs of loosening or corrosion as part of the routine plant maintenance.
- 10.3 Guardbox boxes have been projected to withstand the most severe mechanical fatigue test (more than 1000000 cycles) and accelerated corrosion test (up to 500 hours according to UNI EN ISO9227). However for long-time outdoor usage especially in aggressive environments or if subjected to an elevate number of operations, is recommended to periodically check the correct functionality and integrity of the box. If some parts are damaged, please contact the manufacturer or the local distributor for certified replacement parts.
- 10.4 Maintenance should be carried out by suitably trained personnel to an applicable Code of Practice (eg. EN / IEC 60079-17)
- 10.5 Ensure safety warnings are observed during maintenance.
- 10.6 Eisenbau reserves the right to change or modify products without prior notice or without incurring any obligation to make some changes on products previously or subsequently sold.
- 10.7 All trademarks are property of their respective owners.

11. WARRANTY:

For warranty conditions, please refer to section 7 of document "General terms and condition of sale".

How to order

Product series	Material	Cable entries	Fixing bracket	3D position indicator	Ambient T(°C)	Terminal strip	Switch type & qty	Switch code	Special features
GD									
Aluminium Copper free	A	80x30 h20 2 80x30 h30 3			-25°C +85°C S -25°C +105°C H -40°C +85°C L -60°C +85°C E Customized** X	Nos.2 extra (standard) 2 Customized** 0	Switch qty (enter no.)		Omit (Standard) SIL2* S2 SIL3* S3 Drawing number special features (will be assigned in case of order)
AISI316L Stainless steel	S	80x30 h40 4 130x30 h50 5 not included 0 Customized**C							
Nos.2 M20 x 1,5	N								
Nos.3 M20 x 1,5	M								
Nos.2 M25 x 1,5	P								
Nos.3 M25 x 1,5	L								
Nos.2 1/2"NPT	R								
Nos.3 1/2"NPT	H		Red Closed/Green Open	RG					
Nos.2 3/4"NPT	T		Yellow Closed/Black Open	YB					
Nos.3 3/4"NPT	G		Aluminium rotary disk	AI					
1x M20+1x M25	V		Tempered glass cap	GI					
1x 1/2"+1x 3/4"	W		Blind cover no indicator	BI					
Customized**	Z		Customized**	CI					

Customized or * : please contact our sales team**

Electromechanical SPDT silver plated contacts max 5A@250VAC - 5A@24VDC	01	Insert code number for standard switch or sensor based on list.	81	Magnetic proximity SPDT hermetically sealed max 0,1A@120VAC - 1A@24VDC
Electromechanical SPDT gold plated contacts sealed max 0,1A@250VAC - 0,1A@24VDC	02		82	Magnetic proximity DPDT hermetically sealed max 0,1A@120VAC - 1A@24VDC
Electromechanical SPDT hermetically sealed IP67 silver plated max 5A@250VAC - 5A@24VDC	07		30	Inductive proximity P+F NO NBN4 12GM40 Z0 5-60 VDC 2-100mA 2 wire amplified
Electromechanical SPDT low temperature -60°C silver plated max 5A@250VAC - 5A@24VDC	06		33	Inductive proximity P+F NO NBB2 V3 E2 10-30 VDC 100mA 3 wire amplified
Electromechanical DPDT silver plated contacts max 5A@250VAC - 3A@24VDC	20		34	Inductive proximity P+F NO NBB3 V3 Z4 5-60 VDC 100mA 2 wire amplified
Electromechanical DPDT gold plated contacts max 0,1A@250VAC - 0,1A@24VDC	22	Contact us for complete list of switches and sensors available.	75	Position transmitter 4-20 mA 8...30 VDC programmable - temp. -40/+85°C

Code example:GDAMORGS2MS281

